



UNION CANAL CARRIERS LTD

BRAUNSTON PUMP HOUSE • DARK LANE • BRAUNSTON • DAVENTRY • NORTHANTS • NN11 7HJ

PHONE RUGBY (01788) 890784

info@unioncanalcarriers.co.uk www.unioncanalcarriers.co.uk



Holiday Boat Hire



Welcome Aboard

Introduction

Union Canal Carriers aims to set standards that few hire fleets can match. Because we are as enthusiastic as ever about “canaling” after well over 55 years on the “cut” we are constantly on the look out for ways to improve the design of our boats. Efficiently designed living space, plentiful storage and

comprehensive inventory are at the top of the list. The experienced hirer can step aboard one of our narrowboats and be on their way with the minimum of fuss. The first time hirer will find that the excellent handling capability of our boats, together with friendly advice from our staff, will easily give the confidence

to set off on a fascinating voyage of discovery. A canal holiday can be enjoyed by all ages and offers something of interest to everyone. Your boat becomes your home and the canals offer you freedom, adventure and relaxation.

Your questions answered

How can I book?

Bookings can be done in a number of ways online via our website unioncanalcarriers.co.uk, or for a personal touch you can ring the office on 01788 890784.

What day of the week can we start our holiday?

Boats should be ready for collection from 2pm on the following days: Friday, Saturday, Monday and Tuesday and returned before 9:30am on the last day of hire.

How much experience do I need?

Previous experience is not essential, you will find our boats very easy to steer and control. Our staff will spend adequate time with you to ensure you feel safe and confident.

Where can we go?

There are many routes from our boat yard. Should you wish a leisurely trip with only a few locks, or an energetic week to keep everyone active, we will be happy to advise on routes either before you arrive or on arrival. Cruise planning is made easy by the excellent range of Cruising Guides and Route Planners available from our office. Please feel free to phone for advice at any time.

Can I bring a young family?

Yes of course. Facilities for children include: Safe, high sided back decks on many boats. Buoyancy aids for children, travel cot and bed guards are available.

Can I bring a pet?

Well behaved family pets are welcome on all our boats. There is an additional charge.

Where can we stop at night?

On the canals, moorings are free and the choice is yours. There are many moorings through villages, towns and at canal side pubs. Should you prefer solitude then you are free to tie up at any point along the towpath provided you are not a hazard to passing boats.

Is bedding provided?

Bedding is provided on all our boats. This includes mattress toppers, protectors, sheets, duvets and covers, pillows with protectors and pillowcases. Towels are available to hire for a small cost, complimentary towels are provided for overseas customers.

What is included in the price?

The hire charge shown on our price list includes diesel, gas, bedding, car parking, tuition, damage waiver and cancellation policy.

Do I need to bring groceries?

Click and collect can be arranged with local stores Sainsburys, Tesco and Waitrose. Alternatively call in at the village supermarket or bring your own groceries. Most boating routes have local shops to buy provisions.

What should we bring?

Casual clothes and sensible (rubber-soled) shoes, waterproofs, torches games and DVD's. USB chargers are on all boats. Boxed wines are easier to store than bottles. On board our boats there is cutlery, crockery, kitchen utensils and equipment for the number of berths, as well as a standard domestic-sized fridge (with a small icebox) and a four-ring gas cooker with oven & grill. A full inventory list is available on our website or from the boat yard.



Your Holiday Boats

On board our boats you will find:

- Bedding duvet and pillows
- Sprung mattresses on all beds*
- Central heating
- Continual hot water
- Large shower tray / sit in shower
- Mobile Wifi available
- 4 Ring hob, grill & oven
- Fridge with freezer compartment
- Flatscreen TV / DVD player & USB Socket
- Radio player with Bluetooth / USB connection #
- USB charging points
- Fresh water pump out toilet
- All boats over 60 foot have 2 toilets
- Large front deck with seating
- Fuel for 2 weeks
- Modern quiet engine
- Well behaved pets are welcome aboard

All our boats have semi traditional back decks except Arbury, Hemplow and Selene which have cruiser stern decks #Except Pennine and Chiltern *Except Wenlock bunk beds

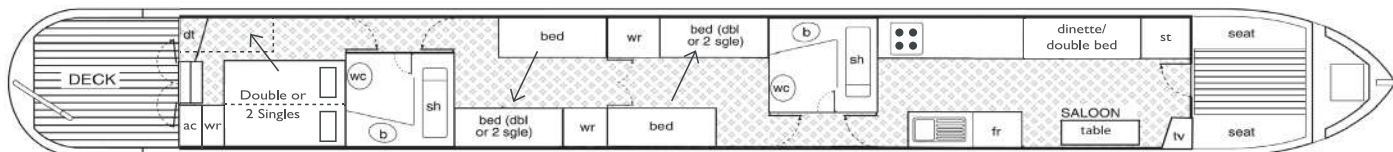

Hemplow 6-8 berth (4 double / 2 doubles & 4 singles / 3 doubles & 2 singles / 6 singles | double) Length 69ft

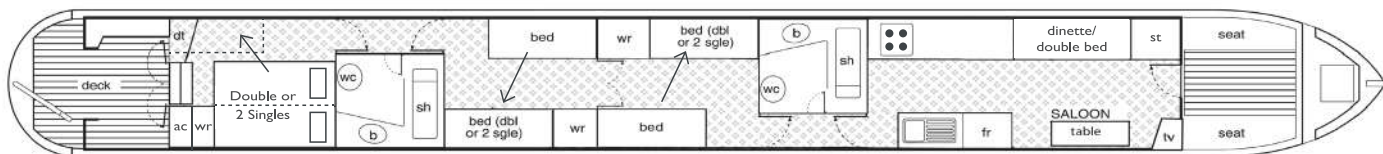

Blackdown 6-8 berth (4 double / 2 doubles & 4 singles / 3 doubles & 2 singles / 6 singles | double) Length 69ft

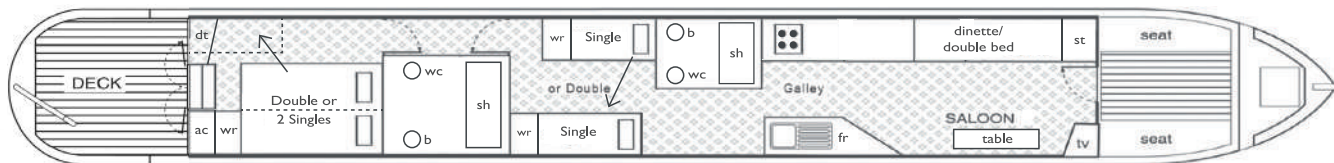

Arbury 4-6 berth (3 doubles / 2 doubles & 2 singles / 4 singles & | double) Length 65ft

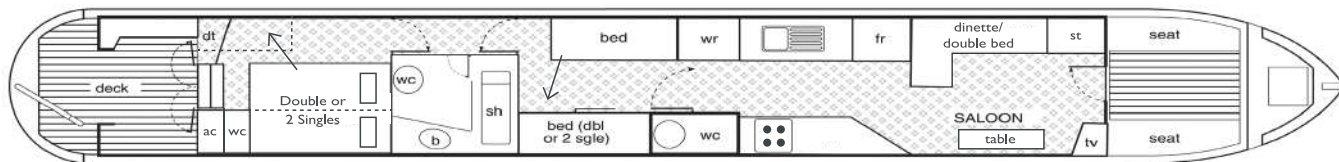

Laughton 4/6 berth (3 doubles / 2 doubles & 2 singles / 4 singles & | double) Length 61ft

wr - Wardrobe, dt - Dressing Table, sh - Shower, b - Basin, wc - Toilet, fr - Fridge, st - Storage, ac - Airing Cupboard

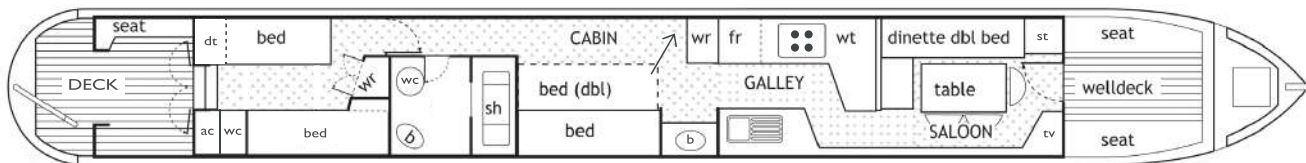

Brendon 4/7 berth (2 doubles & 2 singles + 1 single berth, can be a set of bunk beds for children / 1 double & 4 singles) Length 58ft

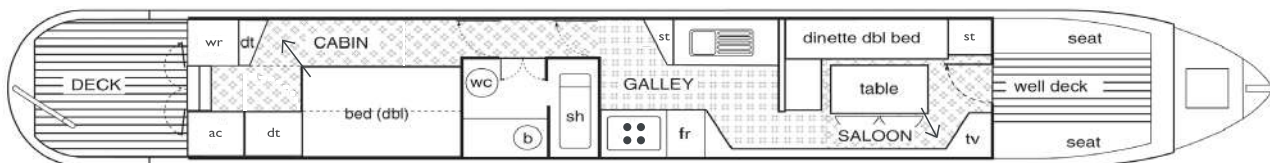

Selene/Cient 2/4 berth (2 doubles / 1 double & 2 singles) Length 49ft

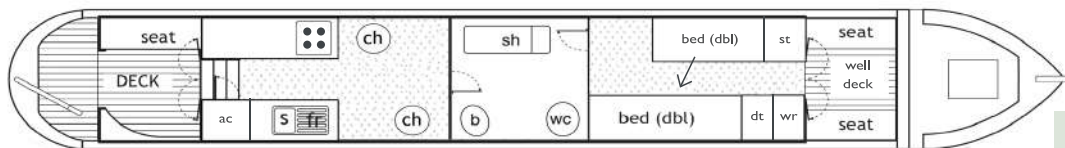

Purbeck (1 double or 2 singles) Length 47ft

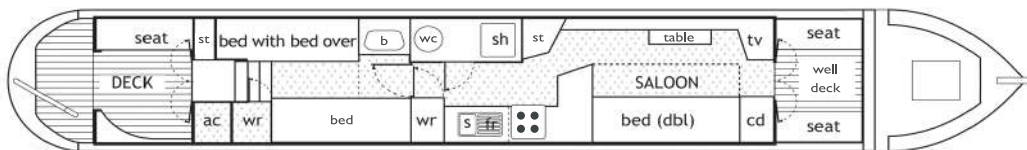

Mendip/Clee 2/5 berth (1 double & 2 singles + 1 single berth, can be a set of bunk beds for children) Length 41ft

wr - Wardrobe, dt - Dressing Table, sh - Shower, b - Basin, wc - Toilet, fr - Fridge, st - Storage, ac - Airing Cupboard

More images of boats can be
found on our website
www.unioncanalcarriers.co.uk



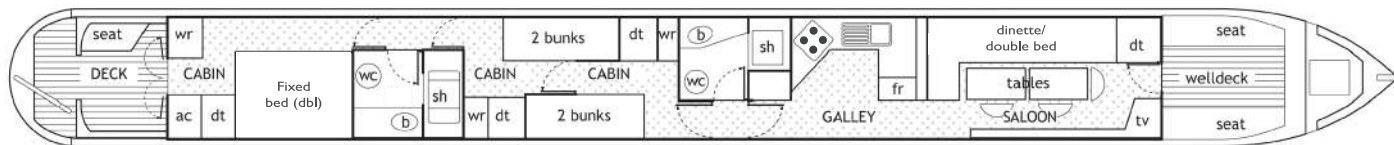

Wenlock 6/8 berth (2 doubles & 4 singles) Length 69ft

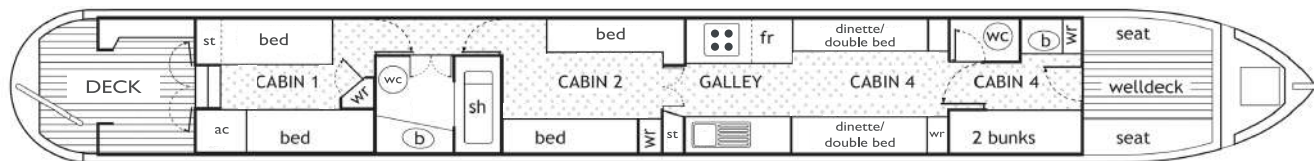

Berwyn (Double & 6 Singles / 8 singles + childs bed) Length 60ft

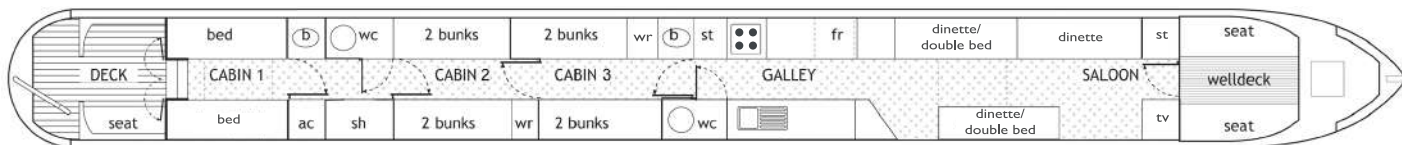

Pennine 12 berth (1 double & 11 singles / 12 singles) Length 69ft

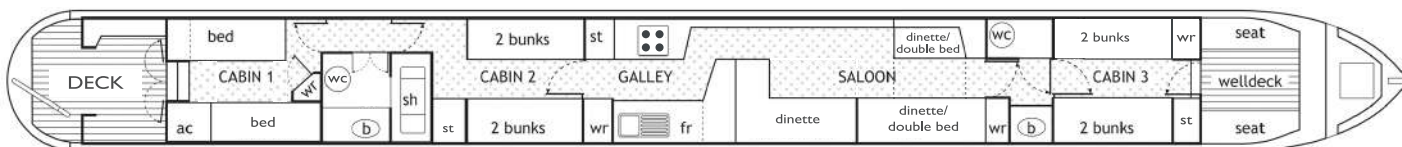

Chiltern 12 berth (1 double & 11 singles / 12 singles) Length 70ft

wr - Wardrobe, dt - Dressing Table, sh - Shower, b - Basin, wc - Toilet, fr - Fridge, st - Storage, ac - Airing Cupboard

Barney Boats



Our Barney boats are ideal for two or a smaller family and very popular with the canal enthusiast with its solid coal fire for heating (smokeless fuel provided) traditional canal decoration, single cylinder engine providing the traditional canal boat sound and small enough to turn almost anywhere.

These are some of the busiest boats in our fleet so please book early to avoid disappointment

Single berth, can be a set of bunk beds for children

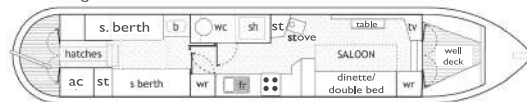

Malvern (1 double & 2 singles + 1 single berth, can be a set of bunk beds for children) Length 40ft

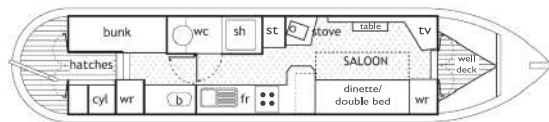

Wrekin/Cheviot 2/3 berth (1 double & 1 small single) Length 35ft

On board you will find

- 4 Ring hob, grill & oven
- Fridge with freezer compartment
- Flatscreen TV / DVD and USB socket
- Radio player with Bluetooth / USB connection
- USB charging points
- Fresh water pump out toilet
- Deep shower tray
- Vanity unit
- One well behaved pet is welcome aboard
- Traditional engine
- Fuel for 2 weeks
- Mobile Wifi available

Weekly Routes

Route 1 Oxford and return

About 48 hours cruising including 78 locks

Half a mile from our base is the junction with the Southern Oxford Canal. There is a feeling of relaxation from your very first meeting with this meandering contour canal. Its narrow lock flights and long lingering vistas across rolling uplands encouraging contemplation, and the local hostelrys beckon at regular intervals. It is not surprising that many people never make Oxford, but everyone enjoys the route; it's a favourite.

Route 2 Snarestone and return

About 32 hours cruising including 8 locks with a tunnel

This was once London's main route to the coal fields, through rural, rolling woodland. Three hours from base you descend the 3 locks at Hillmorton. The following day passing through the stop lock at Hawkesbury, 3 miles along the Coventry Canal you turn right and start the 22 miles of lock free Ashby Canal. The further you go the more beautiful it becomes. Places not to miss include the site of The Battle of Bosworth Field and the little town of Market Bosworth, especially on market day (Wednesday).

Route 3 South on the Grand Union and return

About 44 hours cruising and 54 locks

A wide canal this is the main line of the Grand Union. Not at all busy, especially after you have passed Stoke Bruerne where the Canal Museum is located. Then on to Milton Keynes where the canal passes through the country park with the city centre not far away, should you decide on a shopping spree. The 3 locks and pub at Soulbury signal the start of the climb up the Chilterns and most people wisely make their returning point a few hours on at Leighton Buzzard.

Route 4 Market Harborough and return

About 32 hours cruising including 46 locks

Immediately from our base, you start to climb up through Braunston's 6 locks and tunnel (2042 yards). In a few hours the Watford staircase will bring you to the solitude of the twenty mile pound where flowers, animals and bird life abound. A leisurely day sees you on the lower slopes of the Laughton Hills with the countryside extending below, an unreal feeling. There is the Foxton Double Staircase and Incline Plane Museum before going on to explore the old market town of Market Harborough.

Route 5 Stratford on Avon and return

About 56 hours including 164 locks

Green and rural Warwickshire nearly all the way down to the aqueduct over the River Leam, a quick look at historic Warwick and then the exhilarating climb up the "21 steps to Heaven" of the Hatton Flight before Shrewley Tunnel followed by Kingswood Junction and the turning into the tiny South Stratford Canal and Shakespeare country. The opportunity to tie up overnight in Stratford Basin close by the theatres (did you remember to book?).

Route 6 The Frying Pan – a short circuit and return

About 60 hours cruising including 142 locks

Not for the faint hearted, this one, and calculated to make the kids sleep. Follow the previous route to Kingswood Junction (that's the handle) and keep going straight on up Lapworth and along the beautiful wooded cuttings of the North Stratford Canal to Kings Norton. Then through the very centre of Birmingham, including the very dramatic descent of Farmers Bridge Locks, with buildings towering over head, and back round by Knowle to complete the pan.

Route 7 Oundle and return

About 60 hours cruising including 116 locks

This journey starts by heading south on the Grand Union Canal turning at Gayton Junction before Blisworth Tunnel and descends the locks towards Northampton into the Nene Valley. You join the Nene River at Becketts Park. Once on the river you leave the towns behind and head off into rural Northamptonshire with its small river side villages a peaceful trip to Oundle.

Circular Routes

Route 8 The Warwickshire Ring

Route a) 56 hours & 120 locks b) 52 hours & 94 Locks

Follow route 5 to Kingswood Junction, heading up Lapworth flight towards Kings Norton, Cadbury World and the heart of Birmingham. The return is via the Birmingham & Fazeley Canal, passing Drayton Manor Park before taking the Coventry Canal where you rejoin route No. 2.

Route 9 Leicester Ring

About 67 hours cruising including 100 locks

Follow the Market Harborough route 4 to below the Foxton staircase and continue on to join the River Soar before Leicester. Meander slowly over the wide flood plain and enjoy beautiful wooded cuttings of the Soar Valley to join the mighty River Trent for a mile or two before re-entering the canal system at the well preserved canal port of Shardlow. The Trent and Mersey takes you to the famous Swan at Fradley Junction, returning via Coventry and Northern Oxford Canals.

Route 10 The Grand Ring

About 124 hours cruising including 175 locks

Down the Grand Union, route 4, pass Bulls Bridge, descending to the Thames through Syon Park and Osterly. On to the river via two sets of double locks, where operating times vary with the tides. The Lock Keeper will advise on the best time to pass through. From Teddington you cruise the non tidal river through keeper operated locks to Oxford. The return is as route 1.



* Routes 7 & 10.

Remember: The River Thames and Nene are regulated by separate navigation authorities and you will need to purchase an additional licence. Unlike the canal system, water and moorings along the way may have to be paid for.



Short Break Routes

Route 1 Fenny

Compton and return

About 16 hours cruising
including 18 locks no tunnels

Route 2 Hawkesbury

Junction and return

About 18 hours cruising
including 8 locks with tunnels

Route 3 Stoke Bruerne

and return

About 18 hours cruising
including 26 locks with tunnels

Route 4 Welford Junction

About 20 hours cruising
including 28 locks with tunnels

Route 5 Warwick

and return

About 21 hours cruising
including 50 locks no tunnels

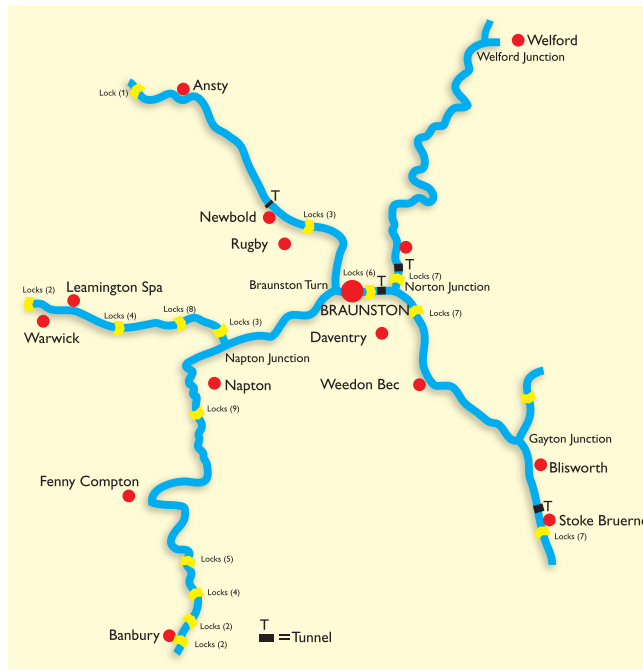

How to find us

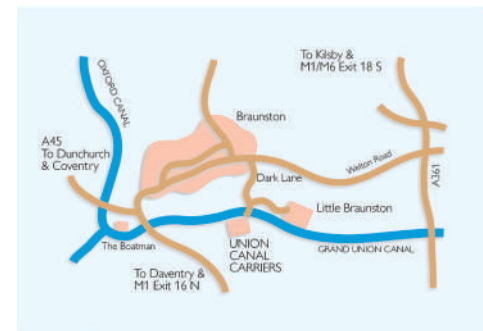

Our base at Braunston is most conveniently situated, being only a few minutes drive from the M1 (exits 18 South or 16 North) and less than a mile from the A45 (East-West route). Close by is Rugby main line railway station which has frequent train services from London and Birmingham with links to major UK Airports.

PROUD MEMBER OF
BRITISH MARINE
LEADING THE INDUSTRY



Union Canal Carriers, Braunston Pump House, Dark Lane, Braunston, Northants NN11 7HJ

Tel: **01788 890784** Email: **info@unioncanalcarriers.co.uk** Web: **www.unioncanalcarriers.co.uk**



Follow us on Facebook



Follow us on Twitter

Updated 2023